

Crafter's Choice

Firm iron-on backing for woven and knit fabrics. No preshrinking required.

Quick and Easy!
Extra Crispness
Adds Strength and Body
Machine Washable

General Directions

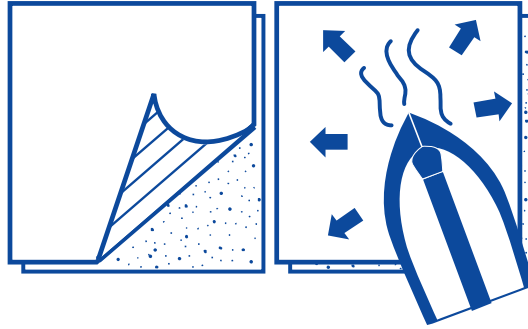

1. Always pre-test on a scrap of fabric, and pre-wash all fabrics.
2. Place shiny adhesive side of Crafter's Choice against back side of fabric.
3. Bond to fabric with hot iron using slight pressure and a gliding motion.

Project Tips

- For large areas, start ironing in the middle of the piece and work out toward the edges.
- For areas that require extra rigidity, use two layers.

Fabric Care Instructions

Machine wash warm. Tumble dry low. Use warm iron.

Special Uses

- Crafts: Create fabric ornaments and photo album covers, flowers, puppets, soft toys, etc.
- Accessories: Crafter's Choice will add body and strength to fabrics for projects such as tote bags, soft luggage, hat brims, visors, etc.
- Home Decorating: Use on a wide range of home decorating projects from bed to bath. Create kitchen accessories, wall hangings, closet organizers, place mats and table runners.

